

Art. no:	58401
Weight:	18,00 kg
Dimensions:	Pipe: 114,3 x 5,6 x 1200 mm
Materials:	Steel Type Pipe: S235 Surface treatment: Galvanized according to DIN EN ISO 1461
Installation:	Pneumatic Ground Screw Driving Machine (Art.No: 12005) Hydraulic Ground Screw Driving Machine (Art.No: 12090)
Use:	Light construction e.g. porches, garden rooms and modular homes.
Fixation:	M12 Bolts

Side view

Cross cut

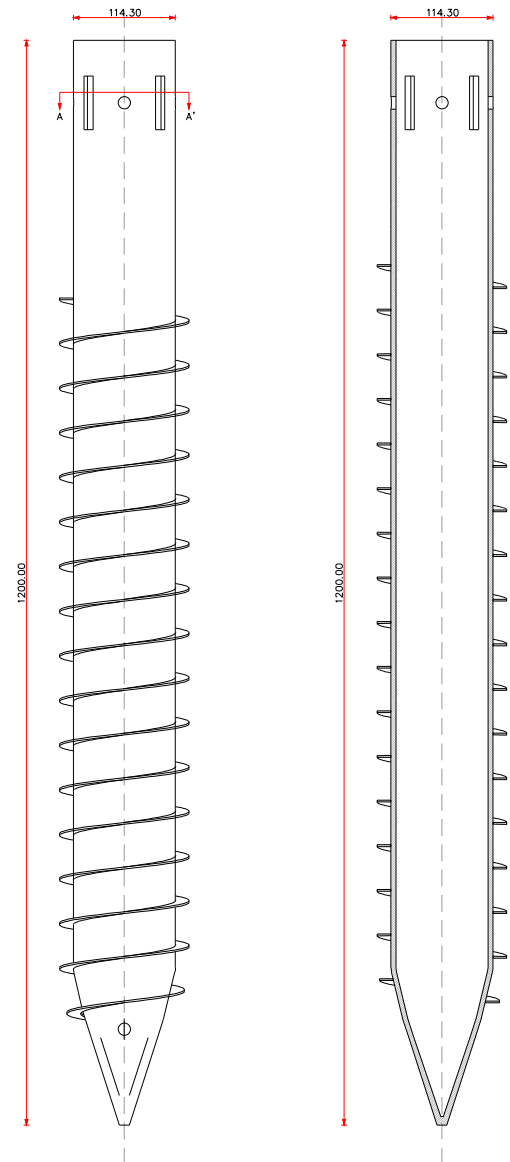

Cross cut pipe (A-A')

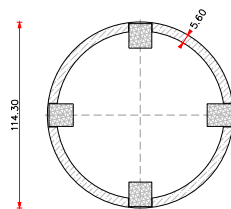

Drawing description	PRO-SERIES GROUND SCREW V-114 x 1200mm	
Date	Signed	Sheet number
12/2018	DVDE	1 of 6
Drawing number	Format	Document status
58401-V1	A4	DEF.

Products to combine:

- 58411 – V-114 EXTENSION 500mm
- 58412 – V-114 EXTENSION 1000mm
- 58413 – V-114 EXTENSION 1500mm
- 58321 – V-114 ROUND FLANGE 220mm