

TECHNICAL DATA SHEET

PRO-SERIES GROUND SCREW Ø76 x 1500mm

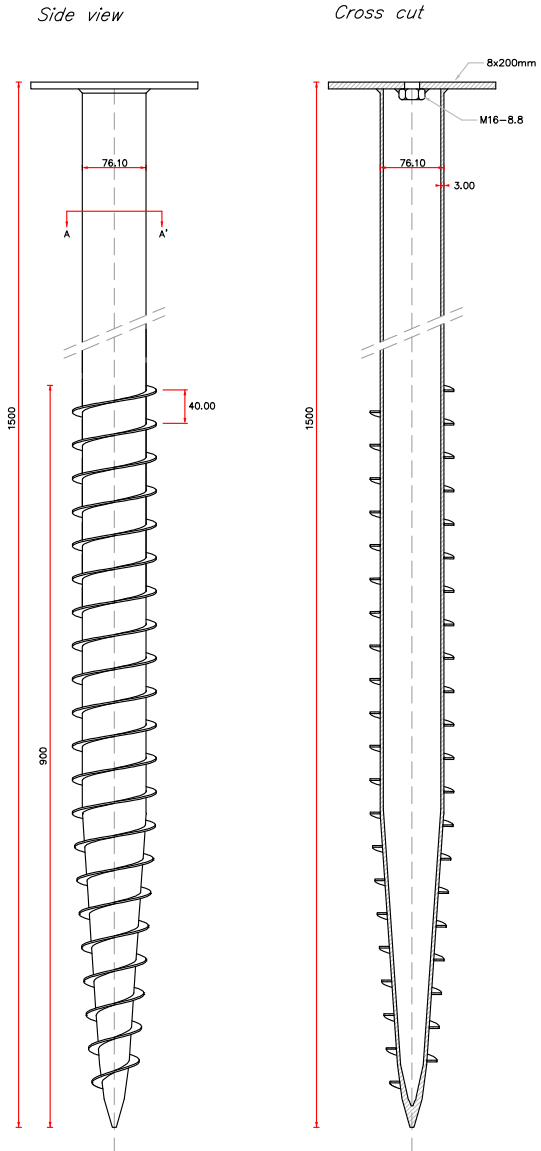

| | |
|----------------------|---|
| Art. no: | 31043 |
| Weight: | 11,00 kg |
| Dimensions: | Pipe: 76,1 x 3,6 x 1500 mm Flange: 8,0 x 200 mm |
| Materials: | Steel Type Pipe: S235 Steel Type Flange: S355 Surface treatment: Galvanized according to DIN EN ISO 1461 |
| Installation: | Electric Ground Screw Driving Machine (Art.No: 12001) Pneumatic Ground Screw Driving Machine (Art.No: 12005) Hydraulic Ground Screw Driving Machine (Art.No: 12090) |
| Use: | Light construction e.g. porches, garden rooms and modular homes. |
| Fixation: | M16 / M12 / M10 Bolts |



Top view flange

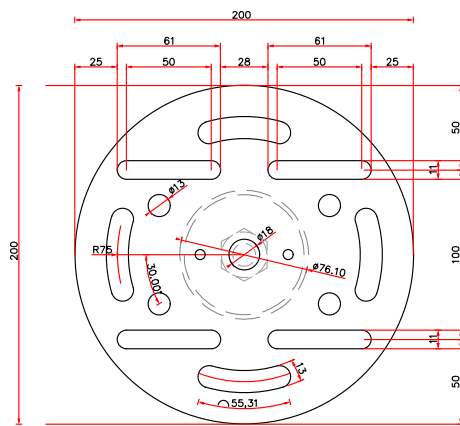

Cross cut pipe (A-A')

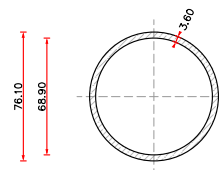

| | | |
|----------------------------|---|------------------------|
| Drawing description | PRO-SERIES GROUND SCREW Ø76 x 1500mm | |
| Date | Signed | Sheet number |
| 12/2018 | DVDE | 3 of 4 |
| Drawing number | Format | Document status |
| 31043-V1 | A4 | DEF. |

Products to combine:

- 17021 – POLEHOLDER M20
- 17022 – L-BRACKET M16 80mm
- 17023 – L-BRACKET M16 160mm

FIRST BASE GROUND SCREWS
Patersweg 2, 5406 XJ
Uden, Holland.

info@firstbasegroundscrews.com
www.firstbasegroundscrews.com
0031 413 432 052

[Click here](#) for the FIRST BASE Load Capacity Chart